

DECLARATION OF ASSETS AND LIABILITIES BY MEMBERS OF LOK SABHA

FORM I

A. ASSETS AND LIABILITIES OF MEMBER

1. Name of the Member (in block letters) **KISHORE DEO**

2. Father's/Husband's name **Late D.P. DEO**

3. Permanent Address **"FORT", V.P.C. KURUPAM
DIST. VIZIANAGARAM - (A.P.)
PIN 535524.**

4. Deih Address **64, LODHI ESTATE
NEW DELHI - 110003.**

5. Party affiliation **INC.**

6. Date of election ~~15.02.2009~~ **16.05.2009**

7. Date of taking oath/making affirmation in the House **02.07.2009.**

I. Details of immovable property

(1) Name of the State, District, Sub-division and village in which property is situated. **V.P.C. Kurupam, Dist. Vizianagaram (A.P.)
(ii) Vill. Thalcheru, Dist. Angul (Orissa).**

(2) Details of property **(iii) Visakhapatnam (A.P.)**

(a) House and buildings and their present value **SILANAPETA KURUPAM
"FORT"**

(b) Lands and their present value **Approx. 1.50 Crores**

(3) Whether held as owner or beneficiary **(i) At Kurupam 178/2 (8.05 Acres) @ 2,00,000/acre
(ii) Gopal Prasad & Balugan (Khanmama) Vill. Thalcheru
Dist. Angul, Orissa (12.00 Acres) (iii) VISAKHAPATNAM
TS DS, 6000 sq. yds @ 35,000/sq. yds.**

→ **Cheruvu (Ancestral property)**

- (4) Whether held jointly or severally. If property held jointly with another person share of property held
- (5) if not held in member's own name, state in whose name held and his/her relationship with the member
- (6) How acquired
(whether by purchase, lease, mortgage, inheritance, gift or otherwise with date of acquisition and name of person from whom acquired)
- (7) Any other relevant information which the member may like to mention

... instances

II. Details of movable property

- (1) Description of the property
(i.e. car/motorcycle/jewellery/ investments in banks/stock markets/companies/financial institutions/ insurance policies etc.)

(i) Cash Rs. 2,00,000/-
 (ii) Deposits in banks, financial institutions - Rs. 30 Lakhs.
 (iii) Bonds, 20 Lakhs.
 (iv) Jewellery of 5 Lakhs.

VEHICLES:-

- (2) Make, model (and also registration No. in case of vehicles) where necessary

(i) Scorpio - 2004 (DL 2CM 9975)
 (ii) Tavera - 2004 (DL EEQ 9999)

- (3) Mode of acquisition
(purchase/gift/mortgage lease or otherwise)

(i) Gifted (By Son).
 (ii) Mortgage/Hire purchase.

- (4) Purchase price of the property
- (5) In case of purchase, source or sources from which financed

(a) personal savings

(b) other sources (ii) Hire purchase from ICICI Bank.

- (6) Any other relevant information which the member may like to furnish

Money provided by State Govt.
 a) A.P. for Security car for M.P's.

III. Details of Liabilities of the member to public Financial Institutions/Central Government and State Government

(1) Details of loans raised from Banks/
Companies/Financial Institutions/Central/
State Governments

(2) Amount of loans raised in each case

(3) The period for which these loans were
raised in each case

B. INFORMATION REGARDING IMMOVABLE AND MOVABLE PROPERTIES HELD BY MEMBER'S SPOUSE

1. Name of the Member's spouse *M. V. KRISHNA DEVI*
(in block letters)
2. Father's/Husband's name *MR. V. KRISHNA DEVI*
3. Permanent Address *FORT L.P.O. KUNNAM,
DIST. VISAKHAPATNAM (A.P.)
PIN 535524.*
4. Delhi Address *64 LODHI ESTATE
NEW DELHI - 110003.*

I. Details of immovable property

- (1) Name of State, District, Sub-division and village in which property is situated
- (2) Details of property
 - (a) House and buildings and their present value
 - (b) Lands and their present value
- (3) Whether held as owner or beneficiary
- (4) Whether held jointly or severally. If property held jointly with member, share of property held
- (5) If not held in spouse's own name, State in whose name held and his/her relationship with the spouse
- (6) How acquired
(whether by purchase, lease, mortgage, inheritance, gift or otherwise with date of acquisition and name of person from whom acquired).

VISAKHA PATNAM (A.P.)

*Girijala (R), Anandapuram,
Visakhapatnam Survey No. 200/2
part and other 92.5 cents
value Rs. 4.10 Lakhs.*

owner

*Purchase a part
(Her share is separate)*

Purchased

- (7) Any other relevant information which the member may like to mention

II. Details of movable property

- (1) Description of property
(i.e., car/motorcycle/jewellery/
investments in banks/stock
markets/companies/financial institutions/
insurance policies etc.)
- (2) Make, model (and also registration
No. in case of vehicles) where
necessary
- (3) Mode of acquisition
(purchase / gift / mortgage / lease or
otherwise)
- (4) Purchase price of the property
- (5) In case of purchase, source or sources
from which financed
- (a) personal savings ✓
- (b) other sources
- (6) Whether held as owner or beneficiary
- (7) Whether held jointly or severally
- (8) Any other relevant information which
the member may like to furnish

Cash - 5 Lacs, Deposits - 10 Lacs
Public - etc. 1 Crore, Bonds - 20 Lacs
Jewellery - 2.5 Lacs.

CAR - Ambassador,

AP 31 Q 6573

AP 31 Q 6573.

Purchased (2nd hand)

1 Lakh 10 thousand

Owner

C. INFORMATION REGARDING IMMOVABLE AND MOVABLE PROPERTIES HELD BY MEMBER'S DEPENDENT CHILDREN

1. Name of the member's dependent children
(in block letters)
2. Father's/Husband's name
3. Permanent Address
4. Delhi Address

I. Details of immovable property

- (1) Name of the State, District, Sub-division and village in which property is situated.
- (2) Details of property
 - (a) House and buildings and their present value
 - (b) Lands and their present value
- (3) Whether held as owner or beneficiary
- (4) Whether held jointly or severally. If property held jointly with member, share of property held.
- (5) If not held in child's own name, state in whose name held and his/her relationship with the child
- (6) How acquired
(whether by purchase, lease, mortgage, inheritance, gift or otherwise with date of acquisition and name of person from whom acquired)

2

X

- (7) Any other relevant information which the member may like to mention

II. Details of movable property

- (1) Description of property
(i.e. car / motorcycle / jewellery / investments in banks/stock markets/ companies / financial institutions / insurance policies etc.)
- (2) Make, model (and also registration No. in case of vehicles) where necessary
- (3) Mode of acquisition
(purchase / gift / mortgage lease or otherwise)
- (4) Purchase price of the property
- (5) In case of purchase, source or sources from which financed
- (a) personal savings
- (b) other sources
- (6) Whether held as owner or beneficiary
- (7) Whether held jointly or severally
- (8) Any other relevant information which the member may like to furnish

Handwritten mark resembling a signature or initials.

DECLARATION

I, W. KISTONE, DFC hereby declare that the information given above is true and correct to the best of my knowledge and belief.

In the event of any change in the information given above, I undertake to intimate the Speaker as provided under the rules.

Yours faithfully,

Date: 16.07.2009

INDIA NON JUDICIAL

ఆంధ్రప్రదేశ్ ఆంధ్ర ప్రదేశ్ ANDHRA PRADESH

Z 725514

Purchased by :
RANI KAMALA DEVI
W/O SREE RAJA PURNACHANDRA
DEO BHANJ (LATE)
VSR
FOR BRON :
SELF

Notarized by :
[Signature]
SRI K. SURESH
NOTARY PUBLIC
SURYABAGH, VISAKHAPATNAM

GIFT SETTLEMENT DEED

(Market Value of the Property Rs. 3,64,04,000/-)

THIS GIFT SETTLEMENT DEED is executed on this the 20th day of May, 2010 at Visakhapatnam by Smt. **Rani Kamala Devi**, age 80 years, W/o late Sree Raja Purnachandra Deo Bhanj, resident of Suryabagh Palace, Suryabagh, Visakhapatnam-530 020 hereinafter referred to as 'the **DONOR**', which expression shall, unless repugnant to the context, mean and include her legal heirs, assigns, administrators and executors, OF THE ONE PART

IN FAVOUR OF

Smt. **Vyricherla Preeti Deo** , Age 58 years, W/o **Vyricherla Kishore Chandra Suryanarayna Deo**, resident of Fort, Kurupam, Parvathipuram Mandal, Vizianagaram District, hereinafter referred to as 'the **DONEE**', which expression shall, unless repugnant to the context, mean and include her legal heirs, assigns, administrators and executors, OF THE OTHER PART

[Signature]

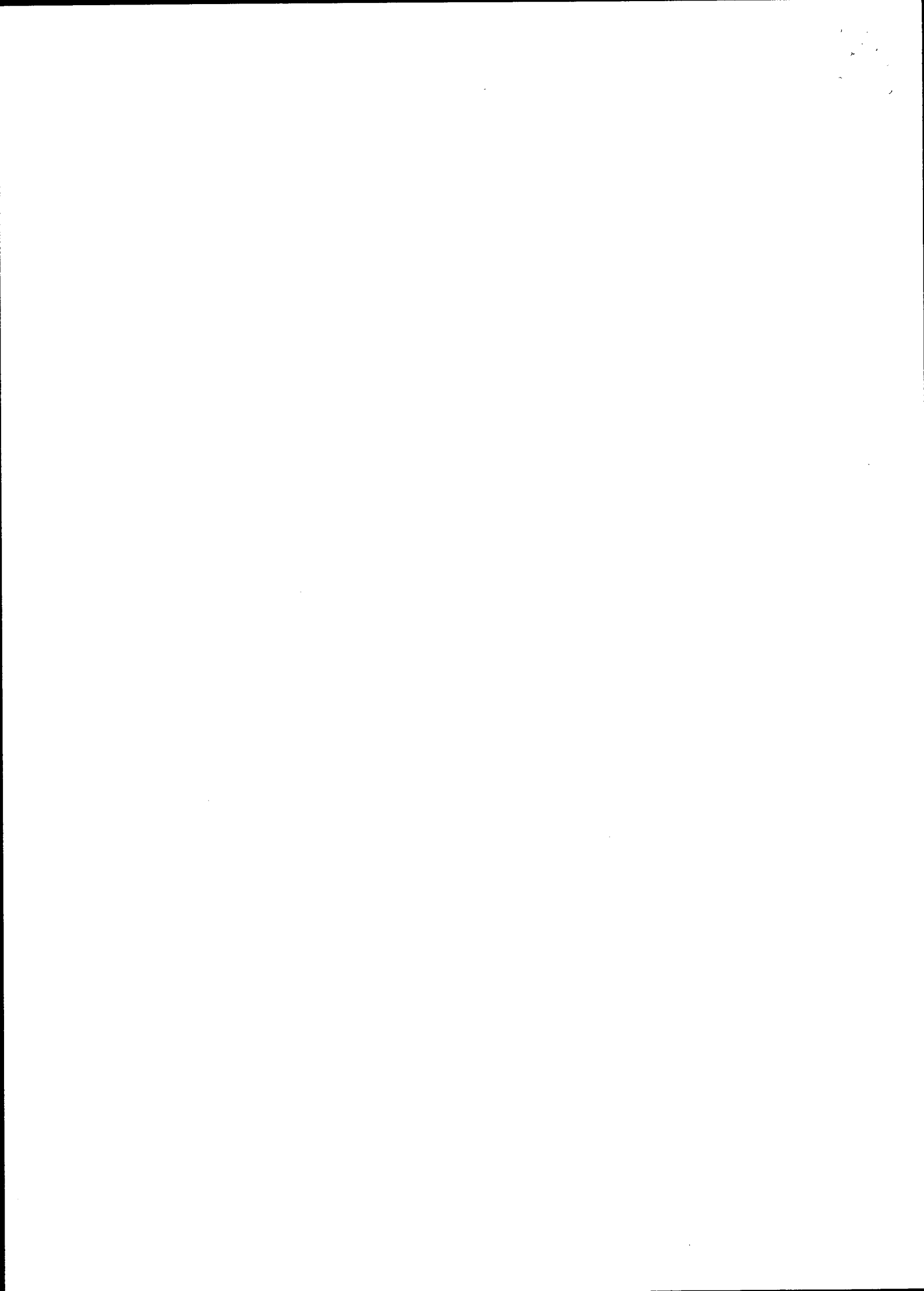

Donee is the elder Daughter of the Donor. They have utmost mutual love and affection for each other.

The Schedule Property formed part of the ancient ancestral Estate of late Raja Vyricherla Narayana Gajapathi Raju who is the father of the Donor. During his life-time he (the said Sree Raja Vyricherla Narayana Gajapathi Raju) executed his Last WILL dated 16-04-1938 in respect of his vast Estate and the same was registered as Doc. No. 11/1938 in the Office of the Sub Registrar, Conoor, Nilgiris (which is now in Oothkamund District in Tamilnadu State). In the said Registered WILL, he bequeathed the Land in T.S. Nos. 1028 of Waltair Ward, Visakhapatnam to the Donor, with all absolute rights. Later, he died.

Because of the mutual and reciprocal love and affection among them, and with a view to make a fixed provision for her in life for her welfare and well-being, the **Donor** intended to give away the Schedule Property freely and absolutely to the **Donee** treating such love and affection as the consideration and obtained her unequivocal acceptance for the same in advance.

NOW THEREFORE THIS DEED OF GIFT WITNESSETH:

1. That in consideration of the natural love and affection which the **Donor** had and still has for the **Donee**, she (**Donor**) does hereby and hereunder renounce all her estate, right, title and interest with intent to vest the same in and grant, convey, transfer, give and assure unto and to the use of the **Donee**, freely and voluntarily, the Schedule Property absolutely free of encumbrances with a view to enable her to hold and enjoy the same with all absolute rights forever.
2. That the **Donor** had already delivered physical possession of the Schedule Property to the **Donee** this day prior to the execution of this Deed of Gift.
3. That the **Donee** is entitled to get the Schedule Property transferred in her name in the Municipal, Revenue and all other applicable Records and peacefully enjoy the same perpetually.
4. That it shall be the duty, obligation and responsibility of the **Donor** to clear all out-standings of Land Revenue, Water Cess, and other levies and Taxes, if any, payable in respect of the Schedule Property to the concerned Authorities till this day and shall indemnify and keep indemnified the **Donee** of the same.

Kamala Devi

p-1449/2010

Book / Year 2010 Document No. 4498
No. of Sheets submitted by Presentant 10
Serial No. of the Sheet 2

~~Sub Registrar~~

Endorsement Under Section 41 & 42 Act. II of 1899.

I hereby Certify that proper/ deficit stamp duty of Rs. 363740/- Rupees three lakhs Sixty three thousand has been levied in respect of this instrument from Sri R. Kamala Devi on the basis of the agreed Market value / Consideration of Rs. 36404000 being heigher than the consideration / agreed Market Value

nine hundred forty only

District Registrar Office
Visakhapatnam

Joint sub Registrar
Visakhapatnam

Date:

Date: 15/5/2010

p-1449/2010

4458

Book / Year 2010 Document No. 4458
No. of Sheets submitted by Presentant 10
No. of Computer generated Section 32A forms NA
by sub Registrar Office NA
Total No. of Sheets 10

~~Sub Registrar~~

Registered as document No. 4498 of 2010 (1931) of Book I and assigned the identification Number 4458 2010 for Scanning.

29/7/10

~~Registering Officer~~



5. That with this Gift, the **Donor** ceases to have any right, title or interest whatsoever in the Schedule Property.
6. That the **Donor** hereby covenants with the **Donee**, her legal heirs, executors, administrators and assigns that notwithstanding any acts, deeds or things hereto before done, executed or knowingly suffered to the contrary, the **Donor is now** lawfully seized and possessed of the Schedule Property, free from any encumbrances, attachments, or defects in title whatsoever and that she (**Donor**) has full power and absolute authority to gift the Property to the **Donee** in the manner aforesaid.
7. That the **Donee** shall, hereafter peaceably and quietly hold, possess and enjoy the Schedule property without any claim or demand whatsoever from the **Donor** or other persons claiming through or under her.
8. That the **Donor** covenant with the **Donee**, her heirs, executors, administrators and assigns to save harmless and indemnify and keep indemnified the **Donee**, her heirs, administrators, executors and assigns from or against all encumbrances, charges and equities whatsoever.
9. The **Donor** further covenant that she shall at the request and costs of the **Donee**, her heirs, executors, administrators and assigns, do execute or cause to be done or executed all such lawful acts, deeds and things whatsoever for further and perfectly conveying and assuring the Schedule Property and every part thereof in the manner aforesaid according to the true intent and meaning of this Deed.

SCHEDULE

Vacant Site of the extent of 1536 Sq. Yards (1284.291 Sq. Mts) in T.S. No.1028 of Waltair Ward, within the limits of the Greater Visakhapatnam Municipal Corporation (GVMC) and within the Sub Registration District of Visakhapatnam. Boundaries for the said Site are as follows:

East : T.S. No. 1029
 South : Site which the Donor is donating to her younger daughter Smt. Uttara
 West : Waltair Main Road
 North : Donor's land in the same T.S. No. 1028

The above Plot is demarcated in Red Outlines in the Rough Sketch enclosed.

As the above Plot is uneven, the Measurements of the same are indicated in the said Rough Sketch.

This is not an assigned property.

Kamala Devi.

2010 / 2010 P1449/2010
Document No. 4498
No. of Pages submitted by Depositor 10
Serial No. of the Sheet 3



note: Admitted The Document on the direction
of the Hon'ble High Court of AP. in writ
Petition W.P.No. 15850 of 2010 D 6/7/2010
to release the Document, subject to compliance
with the due Procedure.

~~Sub Registrar~~
Sub Registrar
K. R. K. R.

RULE III STATEMENT

Area	T.S. No.	Extent	Govt. Rate	Consideration	Party's MV
Waltair Ward Visakhapatnam Nearest Door No. 11-8-1/1	1028	1536 Sq. Yds	Rs. 23,700/- per Sq. Yd	Nil	Rs. 3,64,04,000/-

Deficit Stamp Duty, Registration Fee, User Charges etc. of Rs ~~3,65,000/-~~ paid through Challan dated 19-5-2010 of State Bank of India, Main Branch, Visakhapatnam and the same is enclosed herewith.

IN WITNESS WHEREOF the Donor set her hands and subscribed her signatures unto this Deed, on the day and at the place first mentioned hereinabove in presence of the following witnesses:

Kamala Devi.

DONOR

WITNESSES:

1. *P. Bullu*
2. *Prabha Devi Bhanu*

P1449/2010

Year 2010 Document No. 4458

No. of Sheets submitted by Presentant 18

Serial No. of the Sheet 4

~~Joint Sub Registrar~~



PLAN SHOWING VACANT LAND AN EXTENT OF 1536Sq.Yds.
IN S.No.1028 OF WALTAIR WARD, GVMC LIMIT, VISAKHAPATNAM

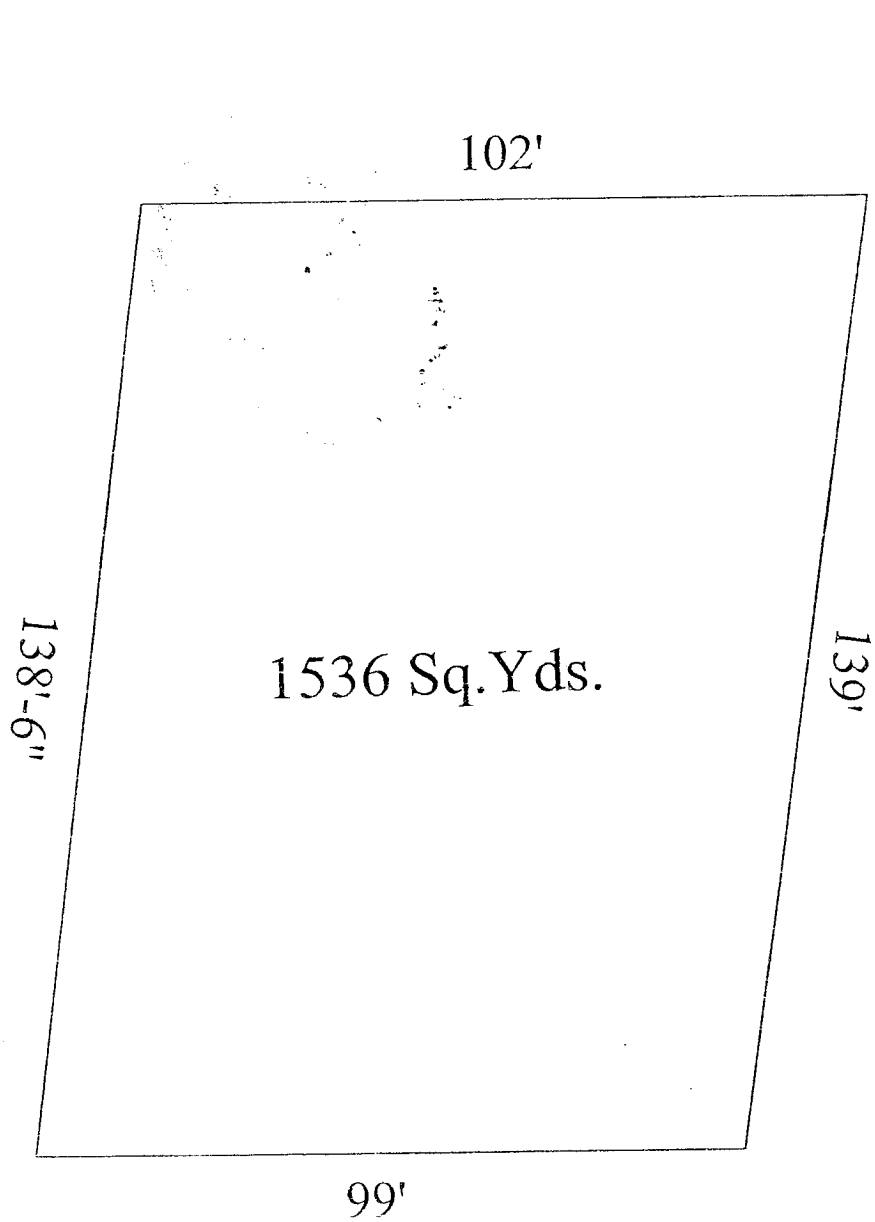

Kanala Devi

P1449/2010

Year 2010 Document No 4458
No. of Sheets submitted by the artist 10
Serial No. of the Sheet 6

~~State Sub. Societal~~



LOCATION PLAN SHOWING THE T.S.No. 1028,1029,1030
OF WALTAIR WARD, VISAKHAPATNAM.

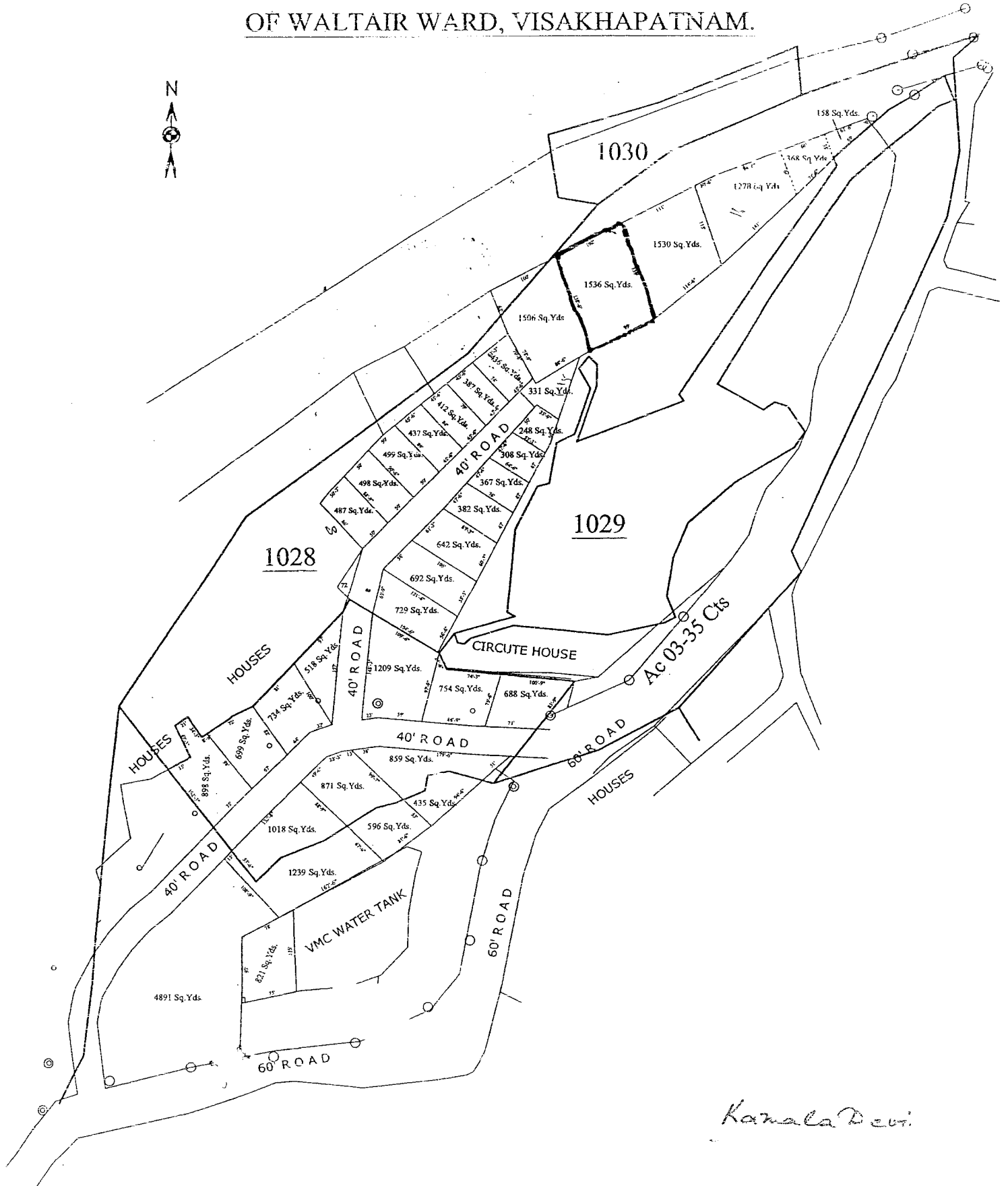





Kanala Devi

Year 2010 Document No. 81449/10
No. of Sheets submitted by Applicant 10
Serial No. of the Sheet 7

~~Joint Sub Registrar~~

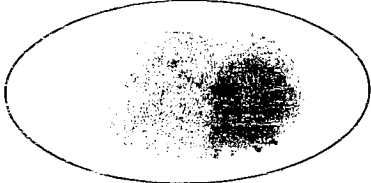

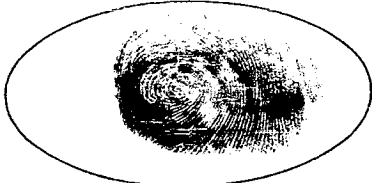
PHOTOGRAPHS AND FINGERPRINTS AS PER SECTION 32A OF
REGISTRATION ACT, 1908.

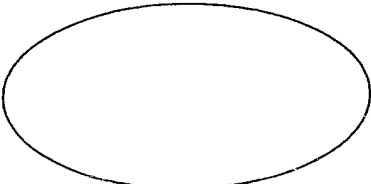
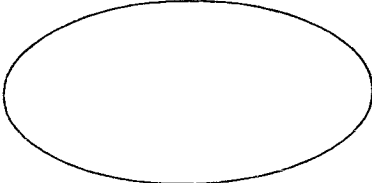
<u>S.NO.</u>	<u>FINGER PRINT IN BLACK INK (LEFT THUMB)</u>	<u>NAME & PERMANENT POSTAL ADDRESS OF PRESENTANT/SELLER/ BUYER</u>	<u>PASSPORT SIZE PHOTOGRAPH (BLACK & WHITE)</u>
1.		<u>Rani Kamale Devi</u> <u>w/o Late Sree Bhat -</u> <u>Purnachandra Deo Bhanj</u> <u>Suryabagh Palega</u> <u>Suryabagh</u> <u>Visakhapatnam</u>	
2.		<u>K. Kishore Chandra</u> <u>w/o K. Kishore Chandra</u> <u>Surya Narayana Deo</u> <u>Folt, Kurupem</u> <u>Poovathi Putram Road of</u> <u>Vizianagaram Dist</u>	
3.		<hr/> <hr/> <hr/> <hr/> <hr/> <hr/> <hr/> <hr/>	Photo
4.		<hr/> <hr/> <hr/> <hr/> <hr/> <hr/> <hr/> <hr/>	Photo

Kamala Devi

SIGNATURE OF THE EXECUTANTS

WITNESSES:

1. *P. Sree Devi*
2. *Prabha Deo Bhanj*

P1449/2010

Year 2010 Document No. 4458
No. of Sheets submitted by Presentant 10
Serial No. of the Sheet 5



7(149)-110

Document No.

Submitted by Presentor

18

~~_____~~
Date: 20/01/20



7/10/49/220

Document No.

of items submitted by Applicant

...

~~...~~



स्थायी लेखा संख्या /PERMANENT ACCOUNT NUMBER

ADGPV8724R

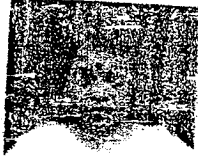

नाम /NAME
PREETI DEO VYRICHERLA

पिता का नाम /FATHER'S NAME
RAJA POORNA CHANDRA DEO
BHANJ

जन्म तिथि /DATE OF BIRTH
31-07-1950

हस्ताक्षर /SIGNATURE



मुख्य आयकर अधिकारी, आंध्र प्रदेश

Chief Commissioner of Income-tax, Visakhapatnam

Year 2010 P1449/2010
No. of Pages submitted by Presentant 4498
Serial No. of the Sheet 9



Election Commission of India
 భారత ఎన్నికల సంఘము
IDENTITY CARD
 గుర్తింపుకార్డు

AP/04/024/189087



Elector's Name **Stut Ranikamaladevi**
 ఓటరు పేరు **శ్రీమతి రాణీకమలాదేవి**
 Father's/Mother's/
 Husband's Name **Parnachandradevbhanj**
 తండ్రి/తల్లి/భర్త పేరు **పర్నచంద్రదేవ్ భంజ్**
 Sex **F** లింగము **(స్త్రీ)**
 Age as on 1-1-95 55
 1-1-95 వాటికి వయస్సు

Address
 28-2-48
 Suryabag (Ward No.13)
 Visakhapatnam
 28-2-48
 సూర్యబాగ్ (వార్డు నెం.13)
 విశాఖపట్నం

Electoral Registration Officer

ఓటరు రిజిస్ట్రేషన్ అధికారి

Visakhapatnam-1 Assembly Constituency
 విశాఖపట్నం-1 విధానసభ నియోజకవర్గము

Place/ ప్రాంతం Visakhapatnam విశాఖపట్నం

Date /తేదీ 15-12-1995

This Card may be used as an identity card under different Government schemes

ఈ కార్డును వివిధ ప్రభుత్వ పథకములలో
 గుర్తింపుకార్డు గా ఉపయోగించవచ్చును

MPIC No : 03/29/03/000/00118/02

64-14

Kamala Devi.

P1449/2010

Year: 2010 Document No. 4498
No. of Sheets submitted by Presentant 18
No. of the Sheet B

~~Sub Register~~



13/10/2011
Sh V Kothare chandhu
298
Sh Bala Gurudh
C Dec
CH